

Nominal dimensions for Socket Cap screws to ISO 4762 / DIN 8912

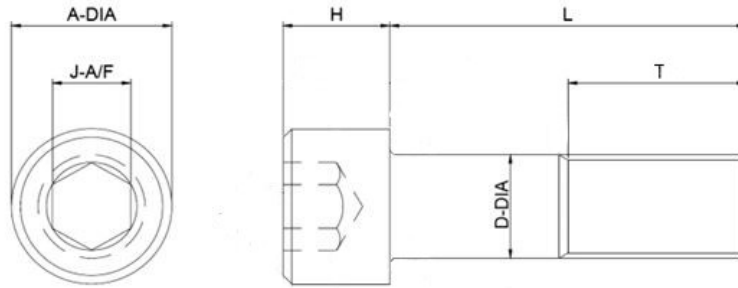

Nom Size	Thread Pitch	Maximum Shank Dia	Maximum Head Dia	Maximum Head Height	Hex Key Size	Max length fully threaded	Thread length for longer shanks
		D	A	H	J	L	T
M1.6	0.35	1.6	3	1.6	1.5	16	15
M2.0	0.4	2	3.8	2	1.5	16	16
M2.5	0.45	2.5	4.5	2.5	2	20	17
M3	0.5	3	5.5	3	2.5	20	18
M3.5*	0.6	3.5	5.7	3.7	2.5/2.8**	30	30
M4	0.7	4	7	4	3	25	20
M5	0.8	5	8.5	5	4	25	22
M6	1	6	10	6	5	30	24

All dimensions are in millimetres

* M3.5 is a non preferred size and so is not covered by ISO or DIN standards - dimensions for M3.5 have been taken from our stock

** Key size for M3.5 can be 2.5mm or 2.8mm (7/64") - please refer to our web page listings for the size for each length option

These dimensions table are also valid for stainless steel cap screws, however fully threaded options for many long shank versions may be available

All information is supplied in good faith but we accept no liability for any errors or variations or for any consequences of its use